

BILL OF MATERIALS

ITEM	DESCRIPTION
1	RHINO POST
2	W-BEAM GUARDRAIL
3	SIGHT RAIL EXTENSION PIECE
4	SIGHT RAIL 32NB
5	M16 x 50mm POST BOLT/NUT
6	M16 x 30mm HEX. BOLT/NUT
7	TEK SCREWS
8	M16 x 32mm SPLICE BOLT/NUT
9	M20 ANCHOR BOLT

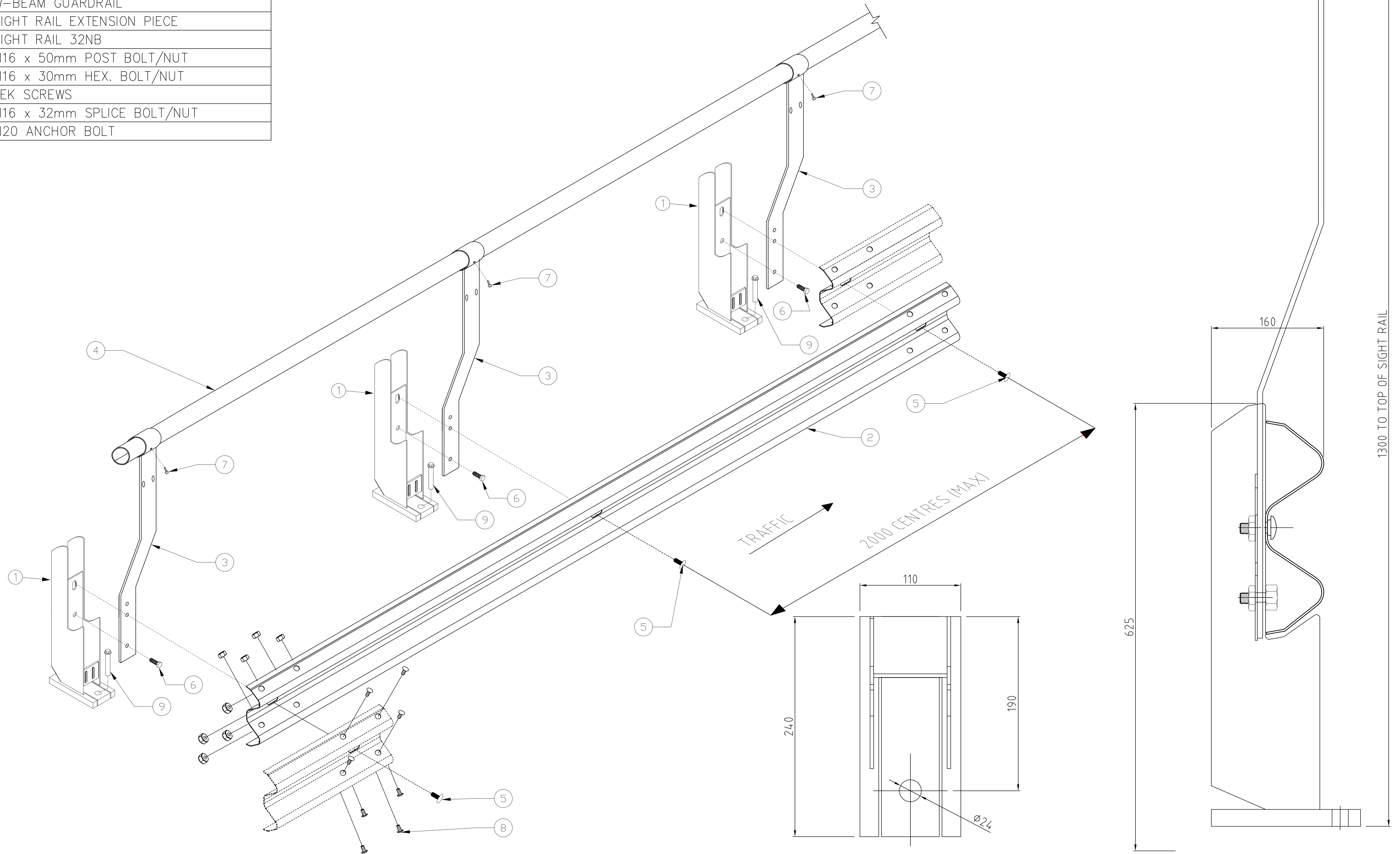

RHINO-STOP HAS BEEN ASSESSED TO EXCEED THE 30kN IMPACT LOAD AS DESCRIBED IN AS/NZS 1170.1 FOR LIGHT TRAFFIC AREAS.

BASE PLATE DETAIL

POST ELEVATION

REV	DATE	DESCRIPTION	DRAWN	APPRD.	REV	DATE	DESCRIPTION	DRAWN	APPRD.
C	13.07.17	HANDRAIL EXTENSION CHANGED.	MS	TC					
B	01.04.15	HANDRAIL EXTENSION CHANGED.	MS	TC					
A	05.11.13	INITIAL ISSUE	DB	TC					



DRAWING DESCRIPTION	RHINO-STOP TYPE 5 ASSEMBLY			
	DRAWN BY	M. SEAL	DIMENSIONS	mm
DRAWING REFERENCE	GR-WB-024			
	CHECKED	H. WALLACE	SCALE	NTS
APPROVED	T. COLQUHOUN			